

ALTIMETRIA LADO IZQUIERDO
ESC. H=1:2500 V=1:250

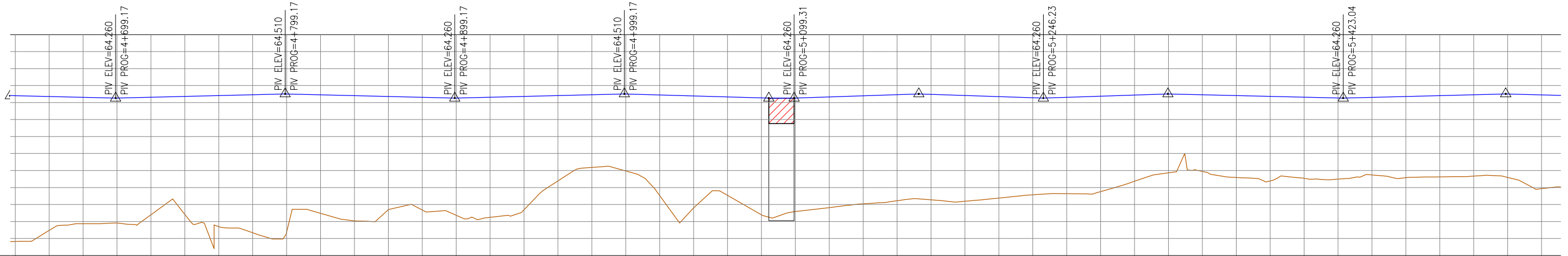

RASANTE
TERRENO NATURAL

PLANIMETRIA
ESC. 1:2500

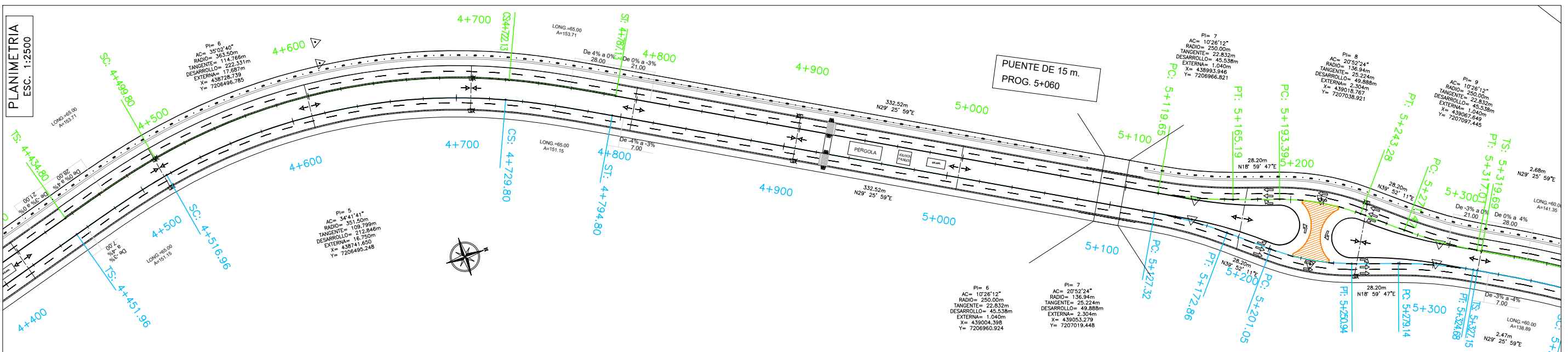

ALTIMETRIA LADO DERECHO
ESC. H=1:2500 V=1:250

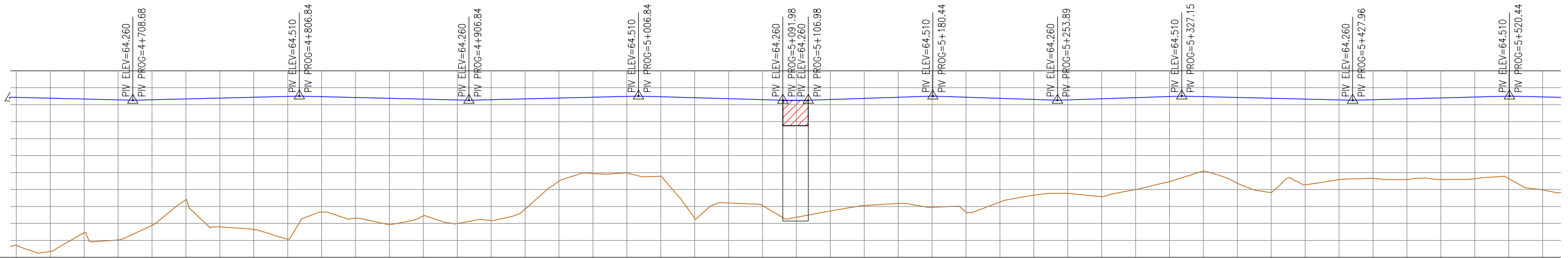

RASANTE
TERRENO NATURAL

REPUBLICA DEL PARAGUAY
 M.O.P.C.
 VICEMINISTERIO DE OBRAS PUBLICAS
 DIRECCION DE VIALIDAD
 UNIDAD NACIONAL EJECUTORA FOCEM

AVENIDA COSTANERA NORTE
 2DA. ETAPA - ASUNCION

PLANI ALTIMETRIA
 4+620 a 5+500

| | |
|----------------------|-------------------------|
| Escalas Indicadas | Lámina DG - 03 - RVO |
|----------------------|-------------------------|